

AERIAL PHOTO  
NTS

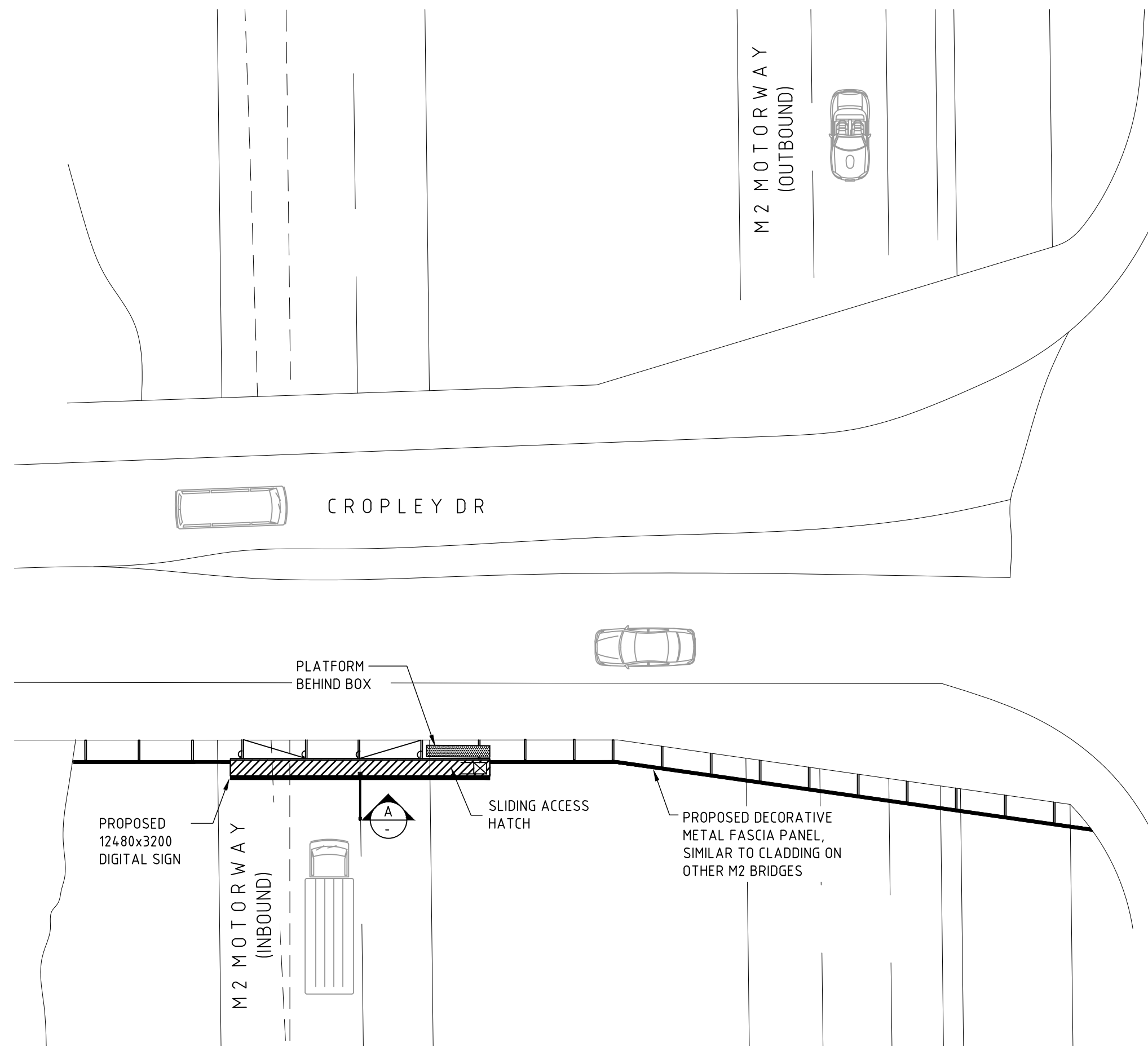

PROPOSED SITE PLAN  
SCALE 1:200

RL'S ARE APPROXIMATE

FALL RESTRAINT CABLE TO BE FIXED BETWEEN SIGNBOX AND BRIDGE

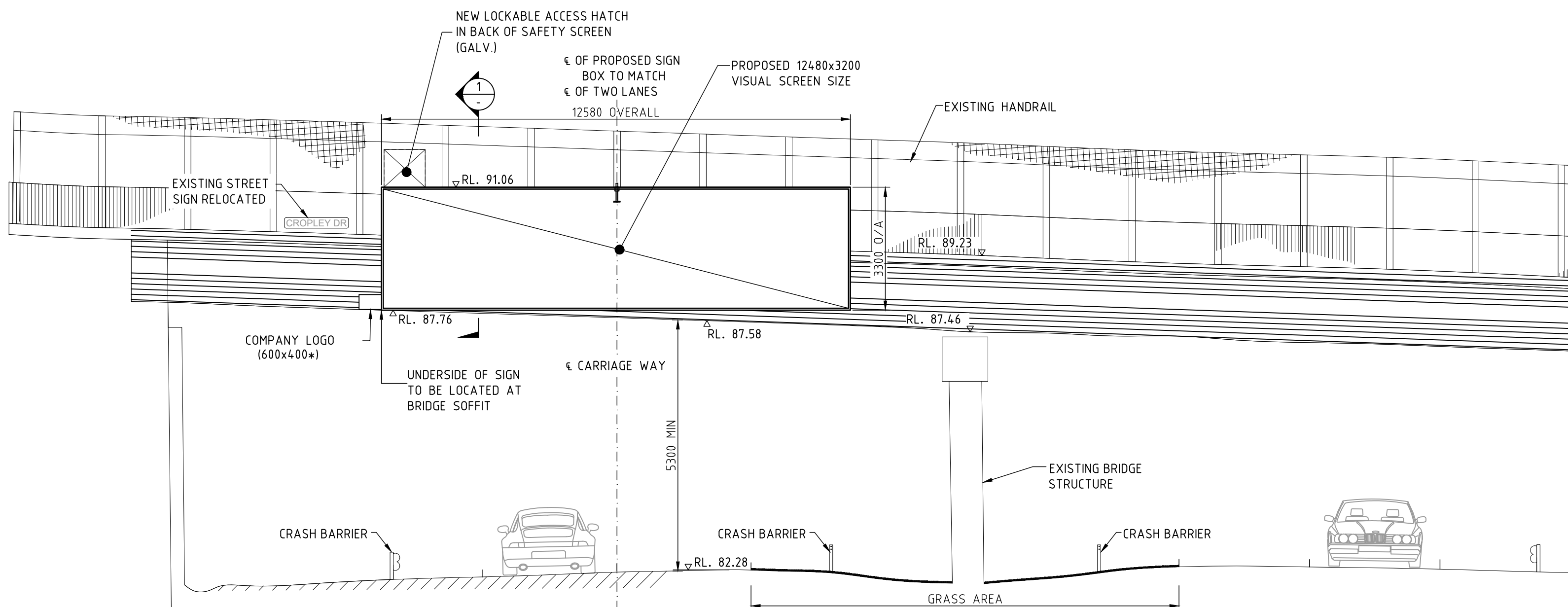

x LOGO DIMENSIONS NOMINAL

ELEVATION A  
SCALE 1:100  
(INBOUND)

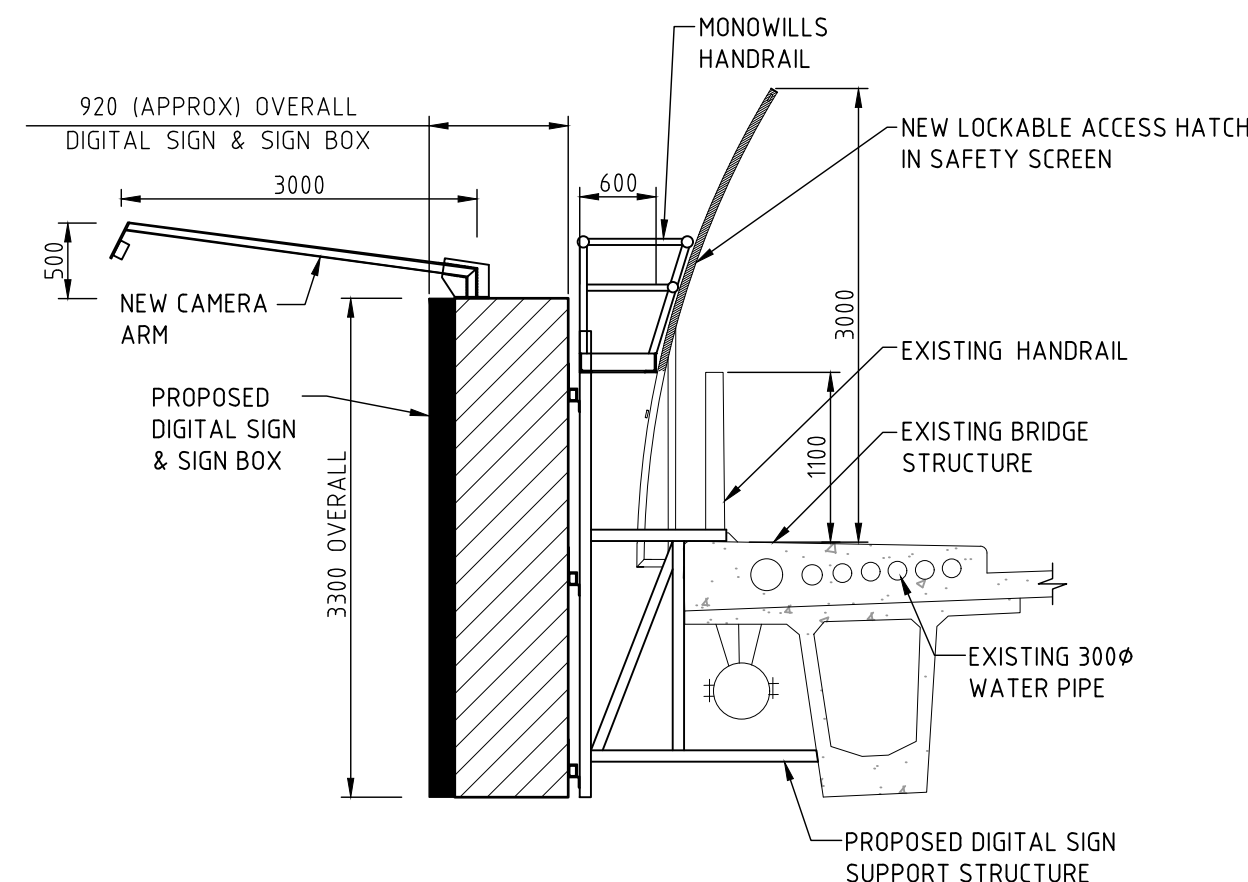

SECTION 1  
SCALE 1:50

NOT FOR CONSTRUCTION

ISS	DATE	COMMENT
A	24/08/22	ISSUED FOR APPROVAL
B	06/10/22	ISSUED FOR APPROVAL
C	17/03/23	ISSUED FOR APPROVAL
D	15/06/23	ISSUED FOR APPROVAL



Suite 4, Building 7, 49 Frenchs Forest Road East,  
Frenchs Forest, NSW 2086  
P.O. Box 652, Forestville, NSW 2087  
Ph: 02 9451 3455 Fax: 02 9451 3466  
Email: info@dbce.com.au  
ABN 23 039 013 724

CLIENT:  
**MANBOOM**  
  
PROJECT:  
CROPLEY DRIVE OVERPASS,  
BAULKHAM HILLS, INBOUND & OUTBOUND

TITLE:  
**PROPOSED DIGITAL SIGNS**  
GENERAL ARRANGEMENT &  
SITE PLAN, ELEVATION &  
SECTION

DRAWN MT	DESIGN JL	DATE: Aug'22
JOB NO: 22141-6	DWG NO: DA01	
SCALE @ A1: AS SHOWN	REV: D	